

PULLEN

ESTATE AGENTS



Muralto Pine Glade

Ovington, BF6 8NT

£5,000,000

Muralto is an exceptional seven-bedroom family residence located within the prestigious Keston Park Estate. This expansive home offers nearly 10,000 sq. ft. of luxury living space.

Upon entering, a grand entrance hall with a vaulted ceiling and atrium sets the tone for the property, leading to an array of impressive reception rooms, including a drawing room, garden room, family room, and cinema room. The bespoke Mark Wilkinson kitchen is a standout feature, with a central island, granite countertops, and high-end appliances, complemented by a separate utility room and boiler room for added convenience.

Viewing

Please contact our Chislehurst Office on 02034899589 if you wish to arrange a viewing appointment for this property or require further information.



7



7



null



C

Floor Plan

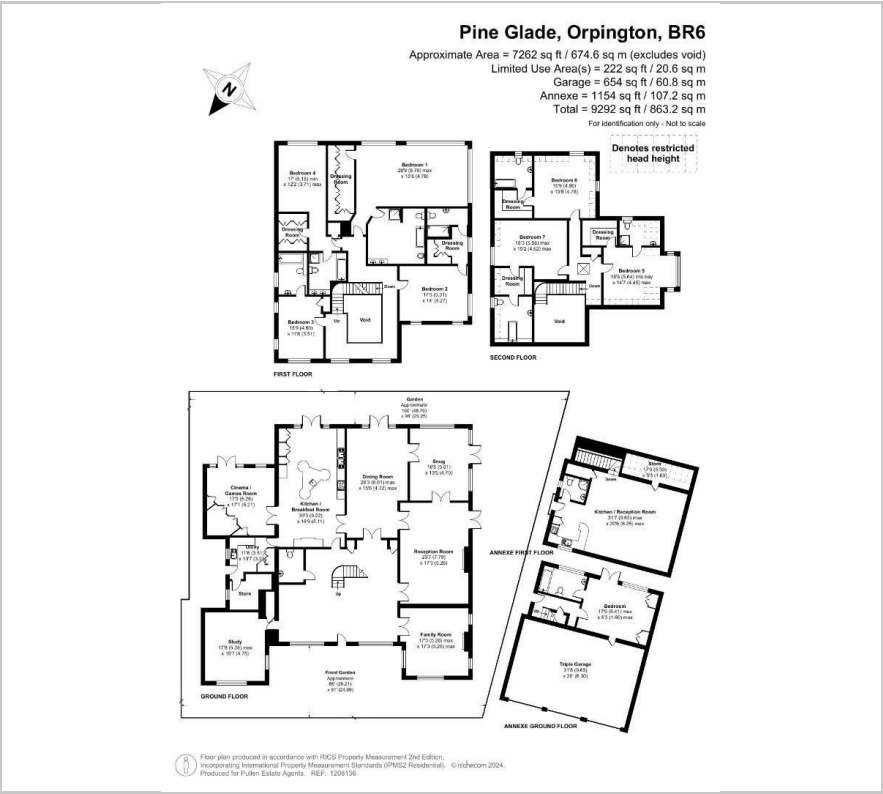

Area Map



Energy Efficiency Graph

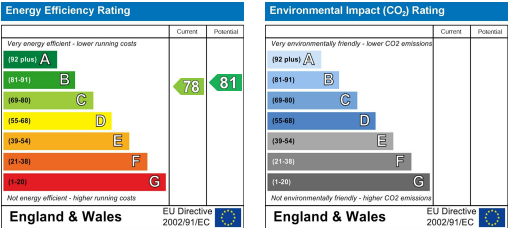

These particulars, whilst believed to be accurate are set out as a general outline only for guidance and do not constitute any part of an offer or contract. Intending purchasers should not rely on them as statements of representation of fact, but must satisfy themselves by inspection or otherwise as to their accuracy. No person in this firms employment has the authority to make or give any representation or warranty in respect of the property.